

RECOMMENDED P.C.BOARD LAYOUT (TOP VIEW)
TOLERANCES UNLESS OTHERWISE SPEC. ±0.05
PAD AREA

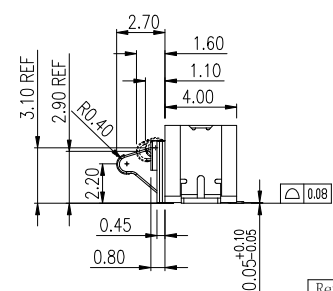

- 1.MATERIAL:
 - 1.1.Housing:HI-TEMP Plastic,UL94V-0,black;
 - 1.2.Terminal:Copper alloy
 - 1.3.Latch:Copper alloy
- 2.FINISH:
 - 2.1 Terminal: 3 u " Au plating on contact area, 2 u " Au plating on other area, underplated nickel over all.
 - 2.2 Latch: 2 u " Au plating on all area, underplated nickel over all.
- 3.Mechical Performance:
 - 3.1 Current rating (single pin):2A MAX.
 - 3.2 Contact Resistance:50mΩ Max;
 - 3.3 Dielectric Withstanding Voltage: 500V AC rms for 1 minut;
 - 3.4 Insulation Resistance:1000 MΩ Min;
- 4.Mechanical Performance:
 - 4.1 Durability:3000 cycles;
 - 5.PACKING:Tape&Reel;

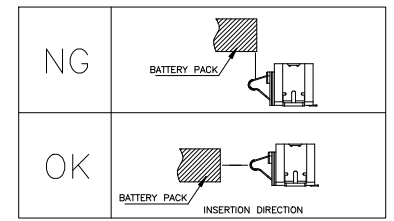
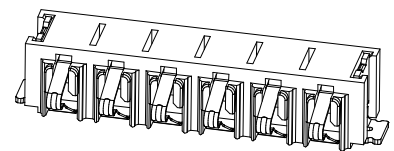

Rev.	ECN Number	Description	Drawn	Date
X1		PRELIMINARY	PING	2018/07/09

DWG NO.	TITLE	REV
DS-163	4.3H 6PIN BATTERY 3.0PITCH TYPE 2 FOR CUSTOMER	X1
PART NO. BC-2-604		SHEET 1/1

迪松电子DISONG

GENERAL TOLERANCE	SCALE	1:1	DRAWN BY	DATE
XX. ±0.30 X. ±0.25 .X ±0.20 .XX ±0.15	UNIT mm		CHECKED BY	DATE
XXX. ° ±4° XX. ° ±3° X. ° ±2° .X° ±1°	SIZE A4		APPROVED BY	DATE