

RoHS
Compliant

SYMBOL	REVISION	APPROVAL	DATE

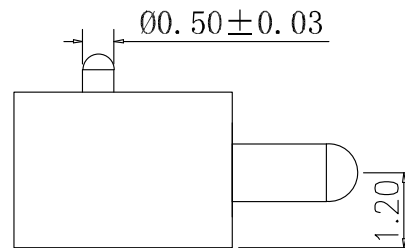
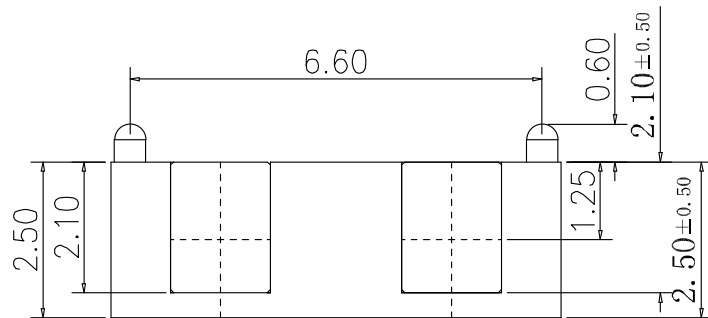
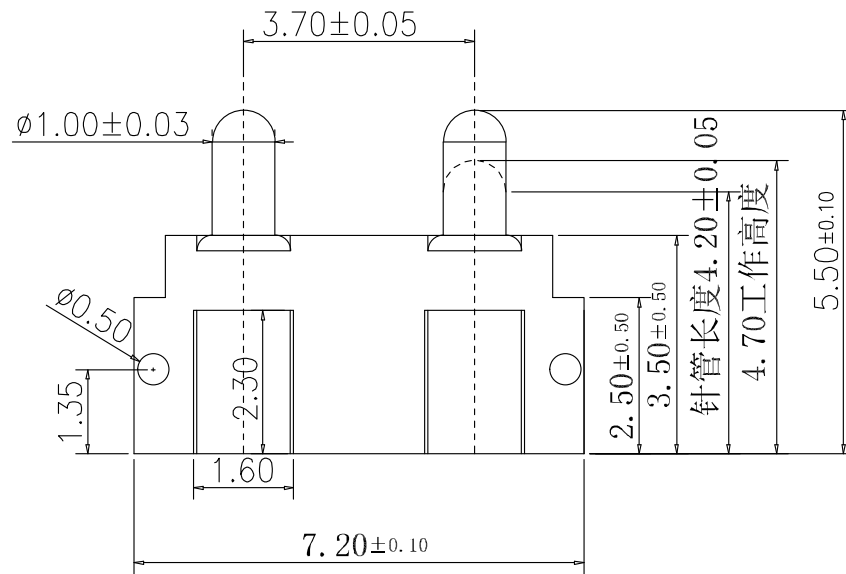

Note:
 1: Material(材料)
 Housing: PA46 (胶芯:PA46)
 Barrel: Brass C3604 (针管: 国标黄铜 C3604)
 Plunger: Brass C3604 (针轴: 国标黄铜 C3604)
 Spring: SUS304 (弹簧: 不锈钢 SUS304)
 2: Plating(电镀)
 Barrel: 2u' Au over 50~80u' Ni (针管: 镀金2u', 镍底50~80u')
 Plunger: 2u' Au over 80~100u' Ni (针轴: 镀金2u', 镍底80~100u')
 Spring: 1u' Au over 20~50u' Ni (弹簧: 镀金1u', 镍底20~50u')
 3: Electrical(电气特性)
 Rated Current & Voltage: DC 12v:2A (额定电压&电流: 直流12v:2A)
 Contact Resistance: 50 mohm Max. at working height.
 接触电阻: 接触最大阻抗30毫欧 (接触工作高度停止状态下)
 4: Mechanical(机械性能):
 Force: 90G±20% at working height. (工作高度时弹力90g±20%)
 Full stroke: 10000cycles(min) 寿命10000次以上)

2	HOUSING	PPA	1	BLACK
1	CONTACT TERMINAL	C70350	2	Au PLATED
NO.	PARTS	MATERIAL	QTY.	FINISHING

东莞市迪松电子科技有限公司

COPYRIGHT RESERVED, PLEASE DO NOT COPY.

PART NAME		CONNECTOR		DRAWING		DWG. No.	
PART NO.		PG-2-202		CHECK		REV.	
UNIT:		TOLERANCE	UP TO 5 ABOVE 5 ~30	ANGLE	APPROVAL		DATE
mm		OTHERWISE	±0.2 ±0.3 ±0.5 ±3*	0° ±3°	SCALE		PAGE
				2:1		1 OF 1	